

OPERATIONAL CHART

When using the machine for the first time or after exchanging the filter, please allow water to flow through the machine for 3 minutes to eliminate carbon particles.



to make Kangen Water®

press **KANGEN** button



Kangen Water®

pH8.5 - pH9.5

Beauty Water

to make Beauty Water

press **BEAUTY** button



Beauty Water

pH6.0

Kangen Water®

to make Strong Kangen Strong Acidic

press **STRONG ACID** button



Strong Kangen

pH11.0

Strong Acidic

pH2.5

to make Clean Water

press **CLEAN WATER** button



Clean Water

pH7.0

Quick Guide

After manufacturing the machine, our Quality Department runs water through it to test and ensure functionality. After their tests, there may be some residual moisture or even water. This does not indicate that the machine has been used.

1 Installing the diverter



Diverter



Shower head adapter (inner screw)



Foam adapter (outer screw) W22 screw (black)



Foam adapter (inner screw) W24 screw (gray)

3-Pieces adapter set

How to mount a single lever faucet

● Inner screw

Faucet with a shower nozzle



You will need a shower head adapter (inner screw) and a foam adapter (outer screw).

Install part as seen below. Remove the foam part that is already installed.

Shower head adapter (inner screw)

Foam adapter (outer screw) W22 screw (black)



Shower head adapter packing

Shower head adapter (inner screw)

Fixing nut

Foam adapter packing

Foam adapter (outer screw)

Check correct screw size and then tighten the foam adapter at the end of faucet.

Diverter



Tighten the setting nut.

● Outer screw



Remove the old aerator that is already installed.

Use an outer screw foam adapter.

There are two types of foam adapters (M22 black). Select either one.



Fixing nut

Foam adapter packing

Foam adapter (outer screw)

Check correct screw size and then tighten the foam adapter at the end of faucet.

Diverter

Tighten the setting nut.

Use a coin to tighten the foam adapter.

Use a coin to tighten the foam adapter.

Use a coin to tighten the foam adapter.

Use a coin to tighten the foam adapter.

Use a coin to tighten the foam adapter.

Use a coin to tighten the foam adapter.

Use a coin to tighten the foam adapter.

Use a coin to tighten the foam adapter.

Use a coin to tighten the foam adapter.

Use a coin to tighten the foam adapter.

Use a coin to tighten the foam adapter.

Use a coin to tighten the foam adapter.

Use a coin to tighten the foam adapter.

Use a coin to tighten the foam adapter.

● Inner screw



Remove the old aerator that is already installed.

Use an inner screw foam adapter.

There are two types of foam adapters (M24 gray). Select either one.



Fixing nut

Foam adapter packing

Foam adapter (inner screw)

Check correct screw size and then tighten the foam adapter at the end of faucet.

Diverter

Tighten the setting nut.

Use a coin to tighten the foam adapter.

Use a coin to tighten the foam adapter.

Use a coin to tighten the foam adapter.

Use a coin to tighten the foam adapter.

Use a coin to tighten the foam adapter.

Use a coin to tighten the foam adapter.

Use a coin to tighten the foam adapter.

Use a coin to tighten the foam adapter.

Use a coin to tighten the foam adapter.

Use a coin to tighten the foam adapter.

Use a coin to tighten the foam adapter.

Use a coin to tighten the foam adapter.

Use a coin to tighten the foam adapter.

Use a coin to tighten the foam adapter.

2 Setting up the Unit 1 → 2 → 3



Secondary water stand (with suction pad)



Suction pad (1 pc.)



2 Connect the water supply hose.

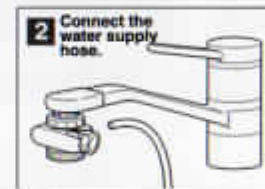

2 Connect the water supply hose.



Insert the hose deep into the branch plug and put a ring on it to fix it tight.

3 Plug in the power cord.

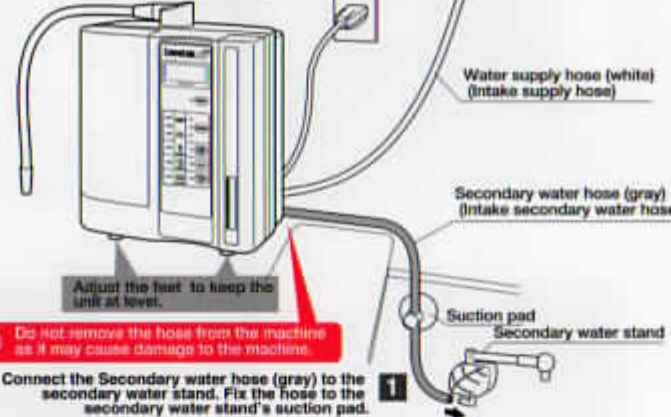

3 How to add electrolysis enhancer

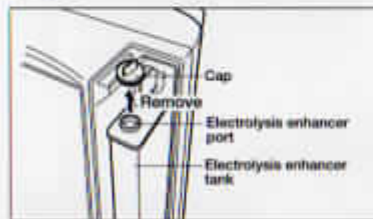

Electrolysis enhancer

Upon moving the machine please remove the enhancer tank; if the tank remains in place while you move it, it may cause serious system damage.